

# HD-351ANT Instruction Manual

Parts#: HD351A7901(1)  
Paper size: Letter size (8.5 x 11in)  
Color: Black Character / White paper  
Scale: 100%  
Date: 08/06/2012

Cut line (No print)

## HD-351ANT Instruction Manual

### 1. Inserting the Batteries

Open the battery cover on the bottom of the platform.  
Insert the AA-batteries as indicated (fig.1).

**Note:**

Be sure that the polarity of the batteries is set properly.  
If the batteries are incorrectly positioned, fluid may leak and damage floors.

If you do not intend to use this unit for a long period of time, it is advisable to remove the batteries before storage.

**Please note that the batteries included from factory may have decreased energy levels over time.**

fig.1

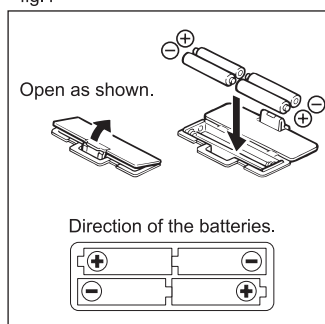

### 2. Positioning the Platform

Place the platform on a hard, flat surface where there is minimal vibration to ensure safe and accurate measurement.

**Note:**

To avoid possible injury, do not step on the edge of the platform.

### 3. Taking body weight reading with the Tanita remote display

1) The platform needs to place within 17 feet (5 m) from the remote display. Interference may occur if multiple platforms are present. Please use only one platform in any given area.

2) Press Weight-only button (  ) to turn the unit on (fig.2).  
**(Do not stand on the platform.)**

3) When the remote display and platform are paired, the platform will beep once and the Green Indicator Light on the platform will blink.

**4) Step onto the platform while the Green Indicator Light is blinking.**

5) After the measurement is complete, the platform will beep twice, weight reading will automatically show on the remote display.

6) Carefully step off platform after measurement is complete.

**Note:**

The HD-351ANT platform is also able to communicate with Tanita software (Healthy Edge™ Plus Software and Healthy Edge™ Lite Software).

Please refer to the software instruction manual for the set-up and measurement process.



### For questions or help with product:

Call Customer Service (847) 640 - 9241 (US & Canada Only)

## HD-351ANT Instruction Manual

### 4. Troubleshooting

- Do not step onto the platform before the platform beeps once and the Green Indicator Light blinks.
- Do not step off until after hearing a double beep or the Green Light remains solid (stops blinking), the measurement is taken, and the reading is displayed on the applicable device (e.g. PC or Tanita remote display).
- If you do not step onto the platform within 30 seconds after Green Indicator Light begins blinking, the power will shut-off automatically.
- **Constant Red Indicator Light**
  - Make sure to step onto the platform only **after** it has beeped twice or the Green Indicator Light is blinking.
  - The unit cannot accurately measure your weight if it detects movement. Please stand on the platform keeping movement to a minimum.
  - Reading cannot be obtained if the weight capacity is exceeded. Weight capacity is 440 lb (200kg).
- **Blinking Red Indicator Light**  
Batteries are low. When the Red Indicator Light is blinking, replace the batteries immediately, since weak batteries will affect the accuracy of your measurements. Change all the batteries at the same time with new batteries.

### 5. Specifications

Weight capacity	440lb / 200kg
Weight increments	0.2lb / 0.1kg
Power supply	DC 6V (4 x AA / LR6 batteries included)
Power consumption	100 mA maximum
Temperature range of usage	41°F to 95°F / 5°C to 35°C



This product is ANT+ certified and is compatible with ANT+ display devices and applications that support the following data:

Visit [http://www.thisisant.com/modules/mod\\_product-directory.php](http://www.thisisant.com/modules/mod_product-directory.php)



### Federal Communications Commission and Canadian ICES Notice

This equipment has been tested and found to comply with the limits for a Class B digital device, pursuant to part 15 of the FCC Rules. These limits are designed to provide reasonable protection against harmful interference in a residential installation. This equipment generates, uses and can radiate radio frequency energy and, if not installed and used in accordance with the instructions, may cause harmful interference to radio communications. However, there is no guarantee that interference will not occur in a particular installation. If this equipment does cause harmful interference to radio or television reception, which can be determined by turning the equipment off and on, the user is encouraged to try to correct the interference by one or more of the following measures:

- Reorient or relocate the receiving antenna.
- Increase the separation between the equipment and receiver.
- Connect the equipment into an outlet on a circuit different from that to which the receiver is connected.
- Consult the dealer or an experienced radio or television technician for help.

### FCC Warning

Changes or modifications not expressly approved by the party responsible for compliance could void the user's authority to operate the equipment.